

Special Key Commands

Firmware V1.6

DIGITAL MIXING CONSOLE

DM7 SERIES

 Hold

 Tap

EQ

Press the following knobs.

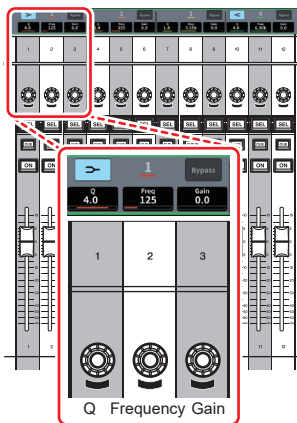

SELECTED CHANNEL VIEW

Q + Gain

Reset the gain of the selected EQ band to 0dB.

Frequency + Gain

Bypass the selected EQ band.

Q + Frequency

Switch the LOW and HIGH bands between shelving and peaking.

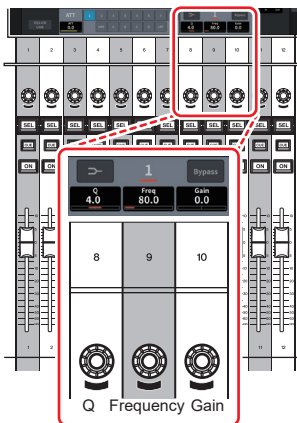

8Band PEQ Edit

SCENE MANAGEMENT

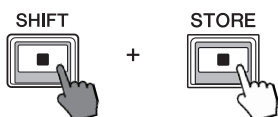

Create a sub scene.

* Using a USER DEFINED key assigned as STORE will also work for this shortcut.

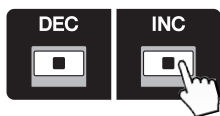

Change the major scene number when storing.

* Using a USER DEFINED key assigned as DEC/INC will also work for this shortcut.



Change the sub scene number when storing.

* Using a USER DEFINED key assigned as DEC/INC will also work for this shortcut.

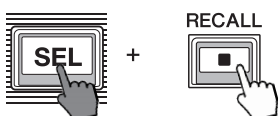

Temporarily recall the selected channel.

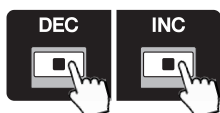

Show the current scene.

* USER DEFINED keys assigned to Scene DEC/INC **WILL NOT** work for this shortcut.



Toggle between the Scene Title and Scene Comment.

* The STORE, DEC/INC, and RECALL keys are located on the DM7 Control Panel only.

SETUP/SYSTEM

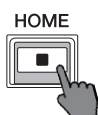

Reset the screen backlight brightness to default.

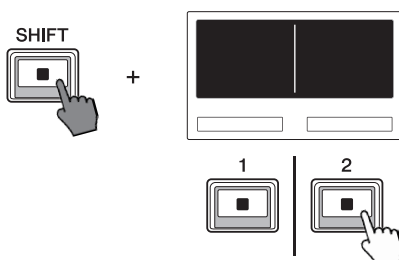

Jump to the CUSTOM FADER screen.

* A custom fader bank must be selected beforehand.

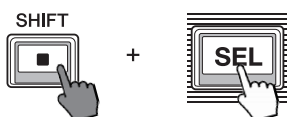

Jump to the selected DCA GROUP ASSIGN screen.

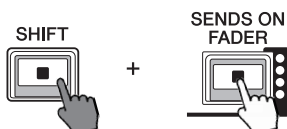

Enter Sends ON Fader mode without opening the SENDS ON FADER screen.

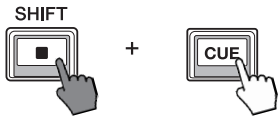

Toggle between CUE group assignment (A → B → A+B →).

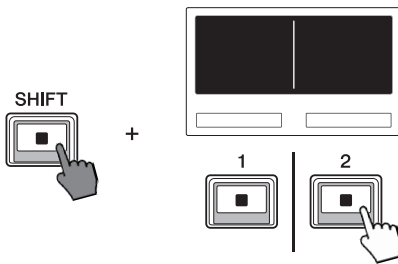

Reverse the order of toggling Surround Panning Positions.

* SURROUND PAN's PANNING TOGGLE function must be assigned to the User Defined Keys.

CHANNEL LINK

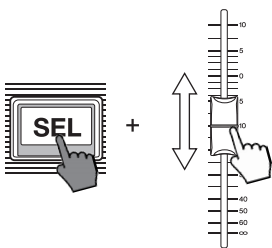

Adjusts the fader level of channel assigned to a link group.

TEMPORARY CHANNEL LINK



Temporarily links the selected channels.

* Press any SEL key to release the linked channels again.

CHANNEL PAIR

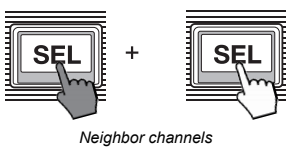

Create/Destroy Stereo paired channels.

MIX MINUS



Assign the mix minus owner channel(s).

* Mix Minus is only available when the Broadcast License is active.